

## HGH-SERIES

### External Gear Cutting Head



**Gear Hob      Hobbing Cutter      Single cutter**

- Heavy cutting available with A large output spindle motor
- Cooling capacity is improved with oil force circulation type of spindle motor
- It is highly suitable to minimize vibration with metal bearing type and performing higher rigidity and precision
- Tool is changed with auto. Tool clamp device.
- Improve convenience, time and safety.

	UNIT	HGH-20	HGH-40
Motor capacity	kw	52	70
Max. Module		24/30	30/40
Max. hob speed	rpm	250	250
Max. hob dia.	mm	Ø320	Ø450
Max. hob length	mm	440	700

### Dimensions

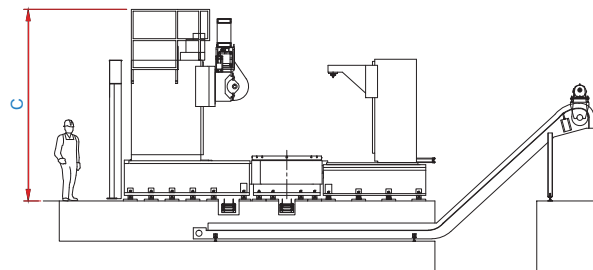
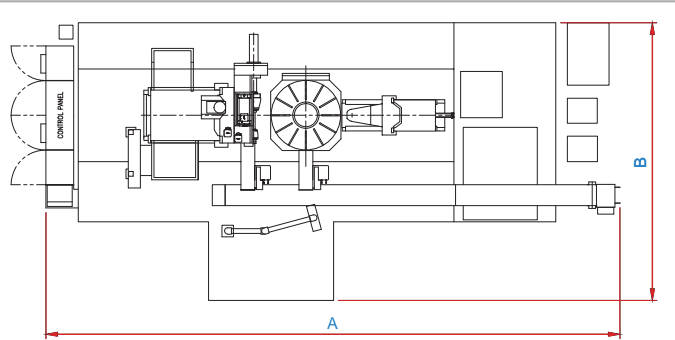

	HGH-20	HGH-40
A (mm)	12,400	15,200
B (mm)	6,000	7,700
C (mm)	4,140	5,500

## HGH ACCESSORIES



**Hob Arbor Set**



**Control Panel**



**Magnetic Conveyor**



**Tail Stock**



**Oil Mist Collector**



**Internal Cutter Head**

### Standard Accessories

- CNC controller (SIEMENS 840D)
- Manual Pulse Generator (M.P.G)
- Air conditioner for electric cabinet
- Hydraulic Unit
- Instruction Manual
- Headstock & Motor cooling devices
- External Coolant System
- Hob Arbor Set

### Optional Accessories

- Tail Stock
- Internal Cutter Head
- Magnetic Chip Conveyor & Chip bucket
- Hob Arbor Set
- Fixtures
- Hob cutter
- Full type of splash guard
- Linear Scale for feedback system (X,Z,A,C)
- Oil Mist Collector



**韓國精密機械(株)**

**HNK MACHINE TOOL CO., LTD.**

<http://www.hnkkorea.com>

e-mail : [hnk@hnkkorea.com](mailto:hnk@hnkkorea.com)

**HEAD OFFICE & FACTORY**

83-1, Yunoe Gongdangil, Beobsoo-Myun,  
Haman-Gun, Kyungnam, Korea  
TEL) 82-70-7019-6500  
FAX) 82-55-580-6699

**U.S.A. BRANCH**

115 S. Wike Road Suite 200A  
Arlington Heights IL, 60005 U.S.A  
TEL) 1-847-921-5551  
FAX) 1-847-604-9206

**BEIJING OFFICE**

Room 912, North Office Tower, Beijing New  
World Center, No. 3B, Chongwenmenwai Street,  
Beijing, China(100062)  
TEL) 86-10-6708-5259 / 5260  
FAX) 86-10-6708-5210

**NORTH AMERICAN IMPORTER  
DYNAMIC INTL., INC.**



N25 W23287 Paul Road  
Pewaukee, WI 5307-4074  
TEL) 1-262-521-1100  
FAX) 1-262-574-0802

**DISTRIBUTOR**

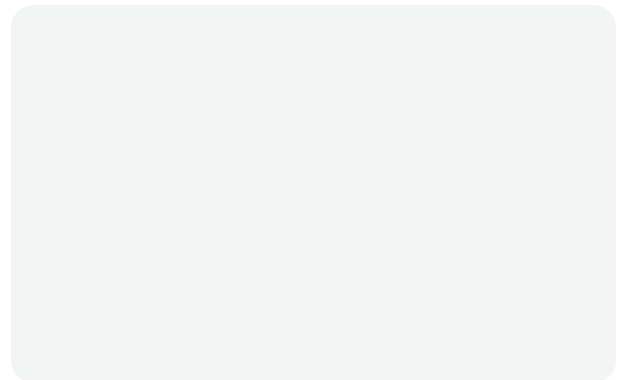

# CNC GEAR GRINDING MACHINE HGG-SERIES



# CNC GEAR HOBBING MACHINE HGH-SERIES



SINCE 1960

韓國精密機械(株)

HNK MACHINE TOOL CO., LTD.

# HGG-SERIES

HGG-Series is Profile Grinding Type of gear grinding machine.

It produces various types of gear with higher speed and more precisely and minimizes dressing time with double dressing system.

Diverse tooth are prepared by tooth fix program and Various Operative convenient devices such as Auto. Balancing, AE Sensor etc.

Furthermore, More reliable gear machining with tooth calibration devices.



## SPECIFICATION

ITEM	UNIT	HGG-1000	HGG-2000
Max. Gear diameter	mm	Max. 1000	Max. 2000
Column Longitudinal Travel (X-Axis)	mm	100 ~ 850(st.750)	100 ~ 1250(st.1,150)
Head Vertical Travel (Y-Axis)	mm	350 ~ 1,000(st.650)	500 ~ 1,500(st.1,000)
Center Support Vertical Travel	mm	500 ~ 1,200(st.700)	730 ~ 1,730(st.1000)
Profile Height	mm	Max. 80	Max. 80
Max. Module for grinding		M1 ~ M35	M1 ~ M35
Grinding Head Swivel	Degr	+45° / -45°	+45° / -45°
Max. Grinding diameter	mm	Max. 400	Max. 400
Grinding diameter (shoulder)	mm	Min. 206	Min. 206
Thickness of grinding stone	mm	Max. 90	Max. 90
Drive capacity	kW	Max. 24	Max. 24
Max. Grinding speed	rpm	Max. 4,000	Max. 4,000
Max. Table diameter	mm	ø500	ø1,100
Table Index	Min-max.rpm	0 ~ 45	0 ~ 45
Max. Load capacity	Kg	3,000	14,000
Table bore diameter x Length	mm	ø210 X 700	ø370 X 190
Dresser diameter x Width	mm	ø120 X 26	ø120 X 26
CNC Control System		SIEMENS 840D	

## HGG-SERIES

### TOOL

#### DRESSER

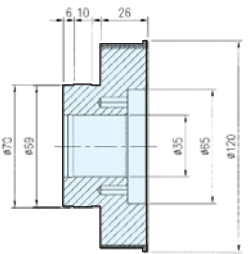

- DRESSER DIA. : Ø120MM (DR.KAISER)

#### WHEEL

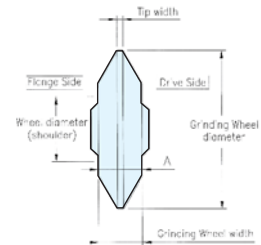

- DEPTH : 30/45/60/90(MM) (TYROLIT)
- GRINDING WHEEL DIA. : MAX. Ø400MM
- GRINDING WHEEL(SHOULDER) : MIN. Ø206MM

### Dimensions

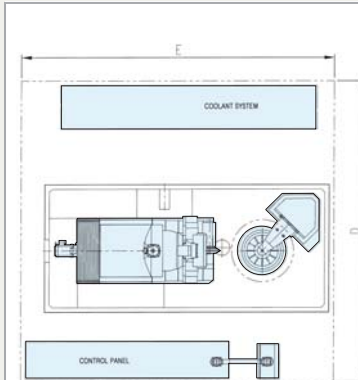

	HGG-1000	HGG-2000
A (mm)	2,000	2,000
B (mm)	3,190	3,410
C (mm)	2,565	2,565
D (mm)	6,415	6,600
E (mm)	5,000	6,300

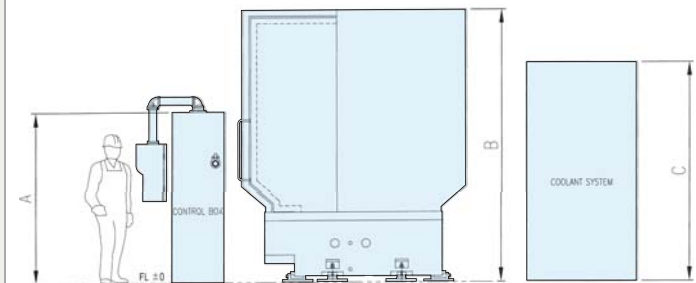

## HGG ACCESSORIES



Full Cover



Control Panel



Gear Calibration System



Vaccum Filtration System

### Standard Accessories

- CNC controller (SIEMENS 840D)
- Manual Pulse Generator (M.P.G)
- Air conditioner for electric cabinet
- Hydraulic Unit
- Instruction manual
- Motor cooling devices
- Vacuum Filtration System
- Auto Wheel Balancing System
- CNC grinding wheel dresser System
- Rotating Control Panel

### Optional Accessories

- Gear Calibration System
- Mineral Casting Body
- Grinding Wheel
- Diamond Dresser
- Filters
- Tail Stock

# HGH-SERIES

By using an inner gear tooth cutting attachment & an outer gear tooth cutting attachment alternately on the same machine, the cutting processes of yaw & pitch bearing can be completed at one set-up.

With the biggest cutting capacity(table and swing size), its application with high speed steel hobber and hobbing cutter (involute insert) maximizes the productivity, operation and precision of huge gears for the large-sized turning tables.



## SPECIFICATION

ITEM		UNIT	HGH-20	HGH-40
Table diameter		mm	Ø1,500	Ø2,000
Max. Gear diameter		mm	Ø2,000	Ø4,000
Max. Table Load Capacity		kg	15,000	30,000
Travels	Column Longitudinal (X-axis)	mm	1,000	2,000
	Hob Head Tangential (Y-axis)	mm	300	450
	Hob Head Vertical (Z-axis)	mm	1,000	1,500
	Hob Head Swivel (A-axis)	deg	-45° to +45°	
	Table Index (C-axis)	deg	0~360	
Feed Rate	Column Longitudinal (X-axis)	mm/min	2,000	
	Hob Head Tangential (Y-axis)	mm/min	500	
	Hob Head Vertical (Z-axis)	mm/min	2,000	
	Table Index (C-axis)	rpm	5	3
External Cutter Head	Motor Capacity	kW	52	70
	Max. Module (Gear Hob)		24	30
	Max. Module (Form Milling)		30	40
	Max. Hob Speed	rpm	250	
	Max. Hob diameter	mm	ø320	ø450
	Max. Hob Length	mm	440	700
CNC Control System			SIEMENS 840D	